

Regular Maintenance After Coating

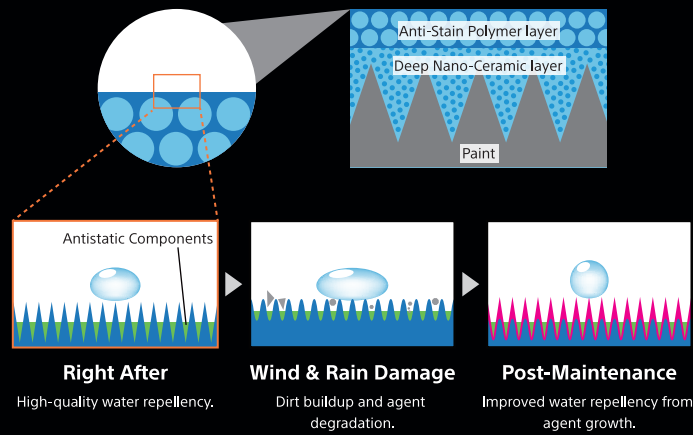

When water repellency weakens or the surface feels rough, it's a sign that maintenance is needed. The Anti-Stain Polymer Shield acts as a protective shield for the paint, and applying it during car washes helps sustain both water repellency and shine.

For best results, use the polymer coating spray during every wash to enhance water repellency and dirt resistance.

LEO Coat's polymer is free of oils and functions solely with hydrophobic agents. The more layers you apply, the greater the effect and the longer it lasts.

In contrast, oil-based coatings have strong water repellency but are prone to oxidation, posing a risk of oil residue on the paint.

LEO Coat Anti-Stain Polymer Shield forms a smooth protective layer, making it the optimal product to preserve your car's beauty without damaging the paint.



Anti-Stain Polymer Shield Refill

The silver-labeled Anti-Stain Polymer Shield is also available in a refill version. This product can also be used as a maintenance agent, so be sure to try it out for regular upkeep. For even greater effect, apply additional layers to enhance protection and shine.



Precautions and Emergency Response Procedures

<General Precautions> If medical advice is needed, have the product container or label at hand to show to the physician. Keep out of reach of children. Read the label carefully before use. <Safety Measures> Read the instruction manual carefully before use. Do not handle the product until all safety precautions have been read and understood. Do not eat, drink, or smoke while using this product. Avoid contact with eyes, skin, and clothing. Do not inhale mist, vapor, or spray. Wash hands thoroughly after handling. <Emergency Measures> If ingested, do not induce vomiting. Rinse your mouth with water and seek immediate medical attention. If inhaled, move to fresh air and rest in a comfortable position. Seek medical attention if you feel unwell. If the product gets into your eyes, rinse cautiously with clean water for several minutes. Remove contact lenses if present and easy to do so. Continue rinsing. Seek medical attention if necessary. If on skin (or hair), remove any contaminated clothing immediately and wash skin with soap and water. Consult a doctor if irritation occurs. In case of spills, collect as much as possible, and flush any remaining residue with water. <Storage> Keep locked up and out of reach of children. Store in a tightly sealed container in a cool, well-ventilated area. Avoid storing in direct sunlight, at temperatures above 40° C or below 0° C, in areas exposed to water, or in high humidity. Do not store the container on its side. Do not store in a vehicle. Keep the instruction manual available for reference until the product is fully used. <Disposal> Dispose of contents and container in accordance with international, national, state, and local regulations.

[Included Items]
- Glass Coating Spray: 80ml
- Polymer Coating Spray: 80ml
- Cloth: 1 piece
- Sponge: 1 piece
- Instruction Manual: 1 booklet

MADE IN JAPAN

Learn more about car coating !

With over 25 years of specialist oversight, LEO COAT brings you this comprehensive guide with over 70,000 characters. Uncover the industry secrets others won't share, learn essential coating knowledge, and get simple maintenance tips to keep your car looking its best. Don't fall for flashy ads—discover the real power of professional-grade coatings with our guide.



LEO COAT

SUPER GLASS COATING



Leocoat.com

- ▶ Affordable Japanese quality
- ▶ Dual-layer for top shine
- ▶ Anti-static cuts dirt
- ▶ Rain-ready in 30 minutes
- ▶ Proven by public institutions

Super Glass Coating with Deep Nano-Ceramic Technology:

The 10nm nano-glass bonds ionically, penetrating and enhancing the paint's hardness through an anchoring effect. This transparent nano-glass maintains the original paint color, providing a clear, glossy finish while being protected by a cellulose mesh layer. Proven through industrial scratch tests, it offers high scratch resistance and a stunning gloss, even with automatic car washes.

Anti-Stain Polymer Shield:

This anti-static nano-polymer coating minimizes dirt and dust attachment, key causes of water spots, and dissipates voltage 1.94 times faster than untreated surfaces. In real-world tests, it significantly reduced tire debris and brake dust. Despite its water-repellent properties, it delivers a smooth, silk-touch finish, giving your car an exceptionally sleek and soft feel.

Please check before application.

- Avoid direct sunlight; it may cause quick drying.
- Prepare a bucket, water, and car washing tools if needed.
- The coating spreads well. Make sure to apply and spread it evenly.
- Before using the spray, unlock the white lock on the head.

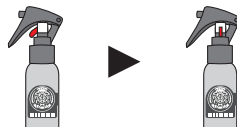

The lock is now unlocked.

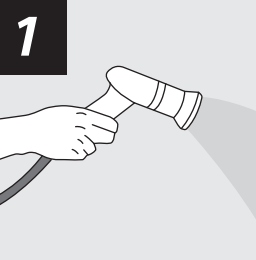

Before starting, wash the car with regular shampoo to remove all large dust and dirt. If any sand or debris remains, it may cause scratches during application. This step can be done using an automatic car wash without any issues.

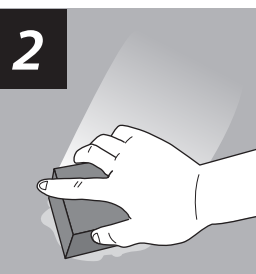

After washing, gently wipe off the water from the car's body using the provided sponge. If you used an automatic car wash and the car was blow-dried, you can skip this step and proceed to the next one.



Take the glass coating spray bottle with the "gold logo" Shake it well for about 5 seconds before use. This product utilizes Deep Nano-Ceramic Technology for enhanced protection and gloss.

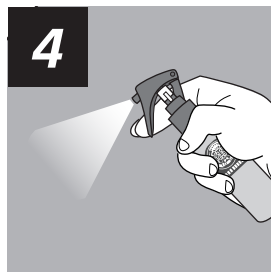

Spray the glass coating from a distance of less than 5 cm from the car's body.

Perform this task across the entire surface, treating each 30cm x 30cm area as one block. Please follow the recommended usage amount mentioned above.

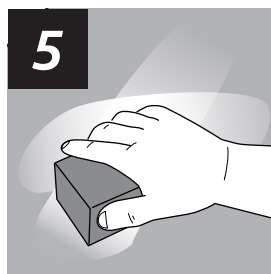

Using a clean, water-dampened, and well-wrung sponge, spread the glass coating evenly in a vertical and horizontal motion without worrying about streaks.



If the body or sponge dries during the process and the glass coating becomes difficult to spread, dampen the sponge with water, wring it out well, and then continue the application.



Allow the glass coating to dry. Once dry, it will form a thin, film-like layer. The drying time is approximately 15 minutes in summer and 30 minutes in winter.

The components of the glass coating bond to the surface through ionic adhesion and penetration, anchoring firmly to the paint.



Remove any excess glass coating. Wipe it off with a well-wetted cloth. If it's difficult to remove, perform a regular car wash with water.

High-pressure washers or high-pressure car wash machines will not remove the coating. If using a car wash machine, a sponge brush type is recommended.



Spray the "silver logo" Anti-Stain Polymer Shield onto a tightly wrung cloth, and apply it to the car body immediately after washing as you wipe it down.

Use one spray per 30cm x 30cm area as a guideline for wiping.

10 If streaking occurs, it's easy to fix.

Try the following methods in order

- A. Rinse, wring, wipe, then dry wipe.
- B. Wash with a cloth, repeat above.
- C. Reapply coating if needed.



11 It can be widely used for maintenance after application on glass surfaces, plastic, chrome, interior, and exhaust.

After Application

For maintenance, please use the polymer spray. (For details, see the back of the packaging.) Store the coating agent in a place away from direct sunlight; it can be used for up to one year. Both the glass coating and polymer coating will be more effective if layered. After the initial application, wait at least 48 hours before reapplying using the same procedure. Since glass coating particles are finer than those in polymer coatings, they will adhere even if previously applied.